

NEW TRIER HIGH SCHOOL

Mobile Modular created temporary classrooms to house students during a high school's two-year phased construction project.

THE CHALLENGE

When New Trier High School's renovation project was approved in a November referendum, they knew they needed to develop a plan to house their students during the two-year phased construction project. Shortly after that school year ended, the old 1931 Tech Arts Building was torn down on the campus, but this required the displacement of students in two separate school years in order to maintain all program curricula. With the bulk of construction work occurring in the last summer it was also important that where the students were displaced would have minimal impact on the site development/restoration schedule.



Customer Name: New Trier High School

Project Location: Winnetka, Illinois

Building Type(s): Modular Classrooms

Job Type: Lease

Total Sq. Ft: 13,720 sq. ft.

THE SOLUTION

The proposed solution to this challenge was to use modular buildings for the Technical Arts spaces. Mobile Modular provided two 7-plex buildings to allow for large-footprint classrooms to appear as one large room for offices, studios, labs, and shop areas. The seams between the seven building units are virtually unnoticeable.

The building gave the high school the ability to replicate its existing spaces in a temporary modular unit without losing any specialty functions or features of the programs that occupied the temporary modular buildings. The basic building construction of the modular units also allowed for easy modifications to support specialty venting/exhaust requirements of the tech arts programs.

Contact Us Today!

866.889.7777 • mobilemodular.com



BUILDING LAYOUT

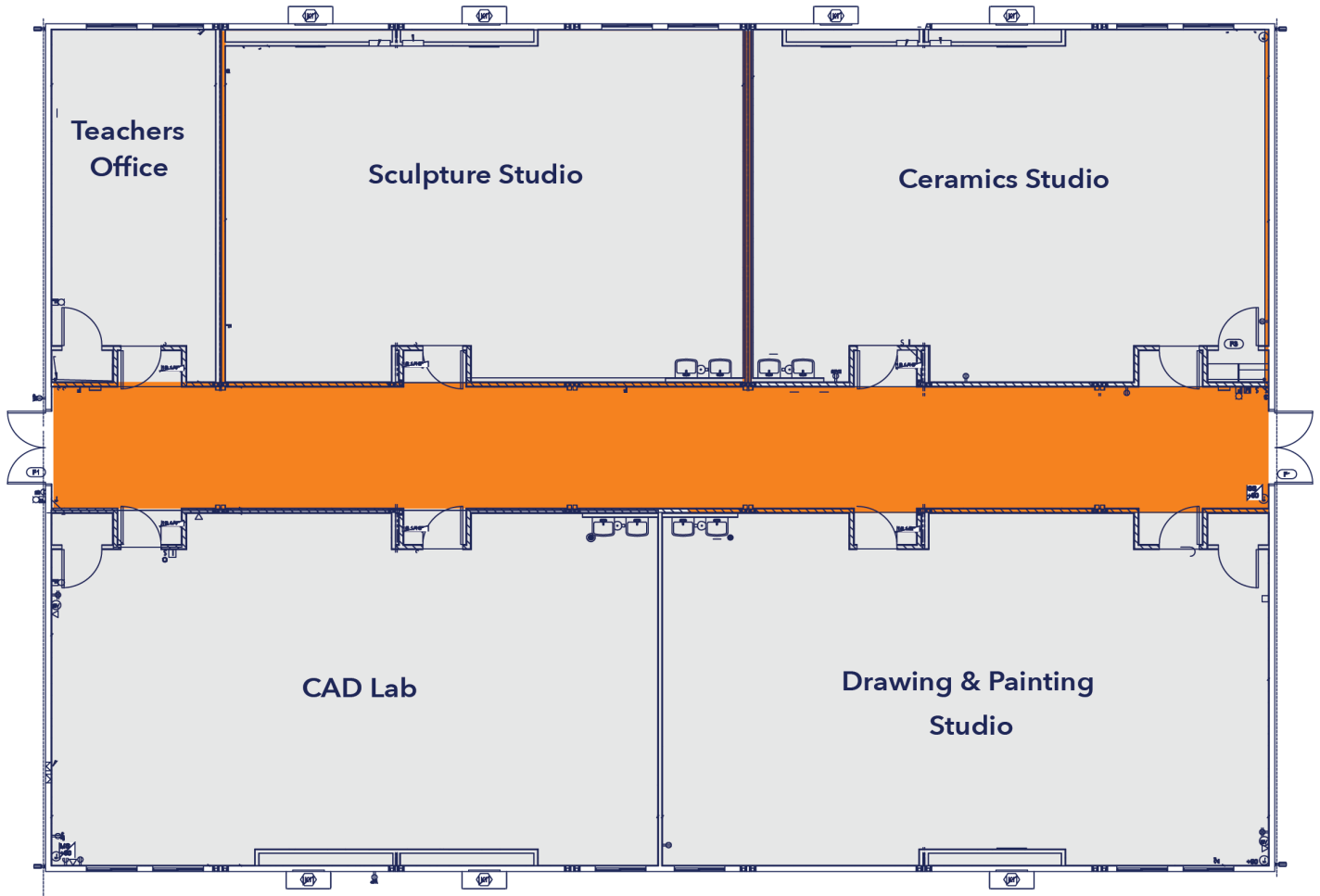

Contact Us Today!

866.889.7777 • mobilemodular.com

